

BELLA TERRA P.U.D. PLAT NO. 4 REPLAT

BEING A REPLAT OF ALL OF LOTS 388 THRU 393,
BELLA TERRA P.U.D. PLAT NO. 4, AS RECORDED IN PLAT BOOK 97, PAGES 135 THROUGH 139,
PUBLIC RECORDS OF PALM BEACH COUNTY, FLORIDA AND LYING IN SECTION 36,
RANGE 41 EAST, VILLAGE OF ROYAL PALM BEACH, PALM BEACH COUNTY, FLORIDA.
FEBRUARY, 2004 SHEET 1 OF 2

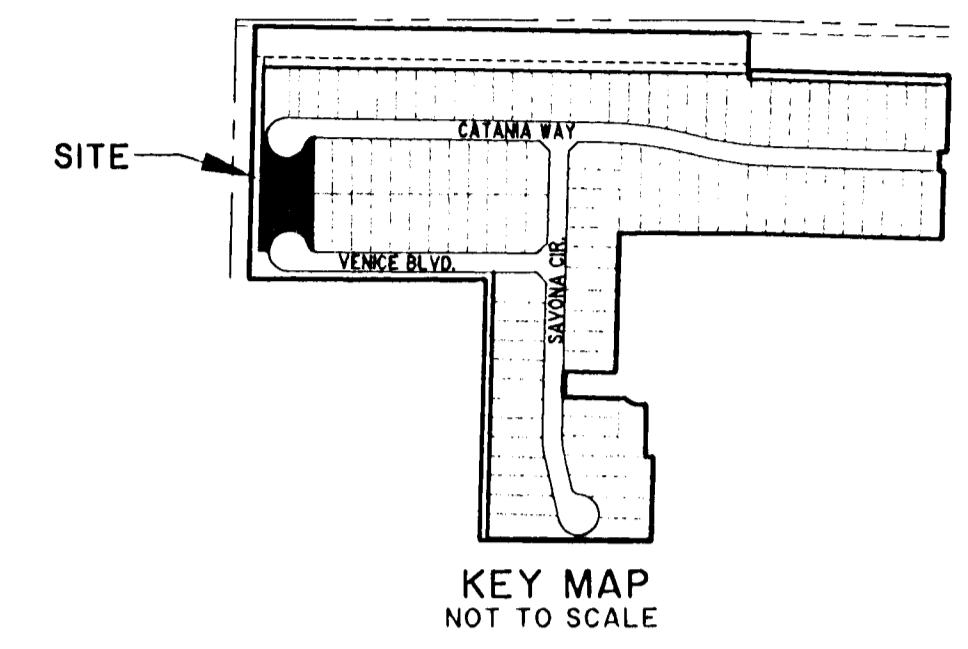

STATE OF FLORIDA SS
COUNTY OF PALM BEACH
THIS PLAT WAS FILED FOR RECORD AT P
M. THIS 28th DAY OF June 2004
AND DULY RECORDED IN PLAT BOOK NO. 102
ON PAGE 10B-109
DOROTHY H. WILKIN, CLERK OF THE CIRCUIT COURT
BY *Alma S. Johnson* D.C.

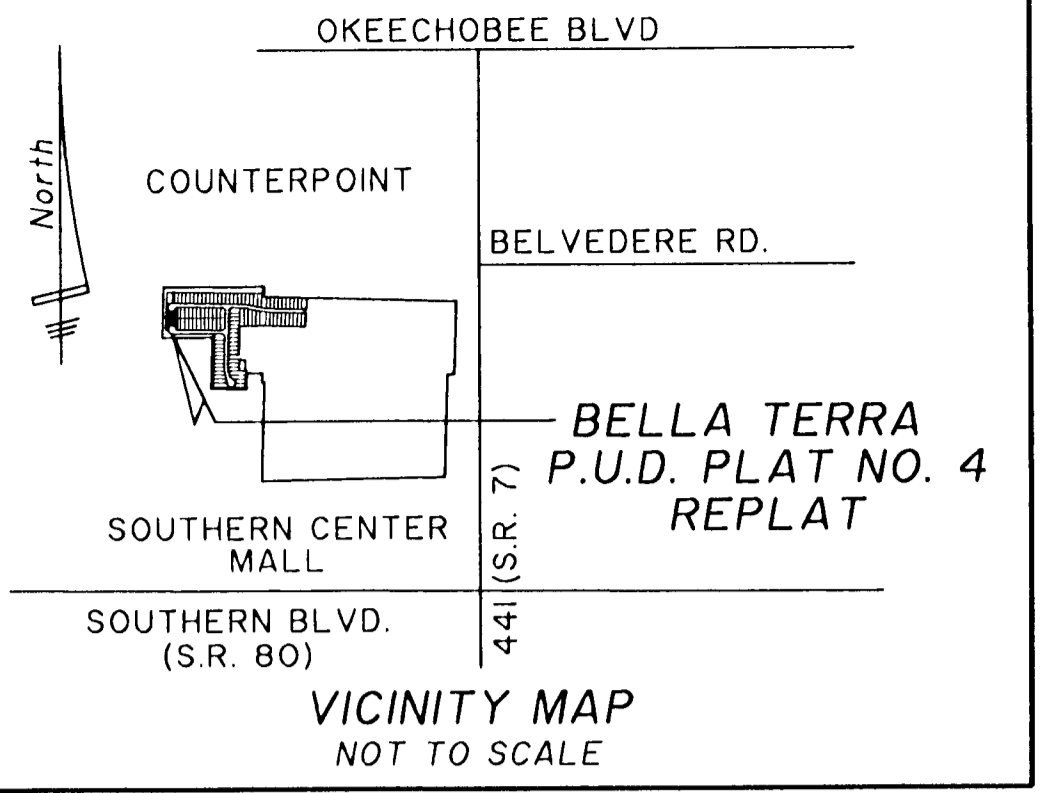

DEDICATION AND RESERVATION

KNOW ALL MEN BY THESE PRESENTS THAT LENNAR HOMES, INC., A FLORIDA CORPORATION, OWNER OF THE LAND SHOWN AND DESCRIBED HEREON AS BELLA TERRA P.U.D. PLAT NO. 4 REPLAT, BEING A REPLAT OF BELLA TERRA P.U.D. PLAT NO. 4, AS RECORDED IN PLAT BOOK 97, PAGES 135 THROUGH 139, PUBLIC RECORDS OF PALM BEACH COUNTY, FLORIDA, AND LYING IN SECTION 36, TOWNSHIP 43 SOUTH, RANGE 41 EAST, VILLAGE OF ROYAL PALM BEACH, PALM BEACH COUNTY, FLORIDA, AND BEING MORE PARTICULARLY DESCRIBED AS FOLLOWS:
ALL OF LOTS 388 THRU 393, BELLA TERRA P.U.D. PLAT NO. 4, AS RECORDED IN PLAT BOOK 97, PAGES 135 THROUGH 139, PUBLIC RECORDS OF PALM BEACH COUNTY, FLORIDA,
CONTAINING 0.685 ACRES, MORE OR LESS.

HAS CAUSED THE SAME TO BE SURVEYED AND PLATTED AS SHOWN HEREON:
IN WITNESS WHEREOF, THE ABOVE-NAMED CORPORATION HAS CAUSED THESE PRESENTS TO BE SIGNED BY ITS VICE PRESIDENT, MICHAEL J. SMOLAK, THIS 23rd DAY OF April, 2004.

ATTEST: *David M. Baselice*
DAVID M. BASELICE,
ASSISTANT SECRETARY
BY: *Michael J. Smolak*
MICHAEL J. SMOLAK
VICE PRESIDENT

ACKNOWLEDGMENT

STATE OF FLORIDA
COUNTY OF PALM BEACH
BEFORE ME PERSONALLY APPEARED MICHAEL J. SMOLAK AND DAVID M. BASELICE, WHO ARE PERSONALLY KNOWN TO ME, AND WHO EXECUTED THE FOREGOING INSTRUMENT AS VICE PRESIDENT AND ASSISTANT SECRETARY OF LENNAR HOMES, INC., A FLORIDA CORPORATION, AND SEVERALLY ACKNOWLEDGED TO AND BEFORE ME THAT THEY EXECUTED SUCH INSTRUMENT AS SUCH OFFICERS OF SAID CORPORATION, AND THAT THE SEAL AFFIXED TO THE FOREGOING INSTRUMENT IS THE CORPORATE SEAL OF SAID CORPORATION AND THAT IT WAS AFFIXED TO SAID INSTRUMENT BY DUE AND REGULAR CORPORATE AUTHORITY, AND THAT SAID INSTRUMENT IS THE FREE ACT AND DEED OF SAID CORPORATION.
WITNESS MY HAND AND OFFICIAL SEAL THIS 23rd DAY OF April, 2004.
MY COMMISSION EXPIRES: Sept 3, 2007
COMMISSION NUMBER: DD239822.
Sandi M. Cooper
NOTARY PUBLIC
PRINT NAME

TITLE CERTIFICATION

STATE OF FLORIDA
COUNTY OF BROWARD
I, GERRY KNIGHT, ESQ., A DULY LICENSED ATTORNEY IN THE STATE OF FLORIDA, DO HEREBY CERTIFY THAT I HAVE EXAMINED THE TITLE TO THE HEREON DESCRIBED PROPERTY; THAT I FIND THE TITLE TO THE PROPERTY IS VESTED TO LENNAR HOMES, INC., A FLORIDA CORPORATION, THAT THE CURRENT TAXES HAVE BEEN PAID; THAT THERE ARE NO MORTGAGES OF RECORD; AND THAT THERE ARE ENCUMBRANCES OF RECORD BUT THOSE ENCUMBRANCES DO NOT PROHIBIT THE CREATION OF THE SUBDIVISION DEPICTED BY THIS PLAT.
DATED: May 19, 2004
Gerry Knight
GERRY KNIGHT, ESQ., P.A.

APPROVAL OF PLAT VILLAGE OF ROYAL PALM BEACH

STATE OF FLORIDA
COUNTY OF PALM BEACH
THE VILLAGE OF ROYAL PALM BEACH, ITS SUCCESSORS AND ASSIGNS, HEREBY APPROVES THE PLAT OF BELLA TERRA P.U.D. PLAT NO. 4 REPLAT DATED THIS 27th DAY OF June, 2004.
VILLAGE OF ROYAL PALM BEACH
A POLITICAL SUBDIVISION OF THE STATE OF FLORIDA
BY: *Norman J. Howard*
MAYOR
ATTEST: *Margaret Yule*
VILLAGE CLERK

ACKNOWLEDGMENTS

STATE OF FLORIDA
COUNTY OF PALM BEACH
BEFORE ME PERSONALLY APPEARED DAVID H. LUDWICK AND *Mary Ann Coe*, WHO ARE PERSONALLY KNOWN TO ME AND WHO EXECUTED THE FOREGOING INSTRUMENT AS MAYOR AND VILLAGE CLERK OF THE VILLAGE OF ROYAL PALM BEACH, A FLORIDA POLITICAL SUBDIVISION OF THE STATE OF FLORIDA, AND SEVERALLY ACKNOWLEDGED TO AND BEFORE ME THAT THEY EXECUTED SUCH INSTRUMENT AS SUCH OFFICERS OF SAID VILLAGE, AND THAT THE SEAL AFFIXED TO SAID INSTRUMENT IS THE SEAL OF SAID VILLAGE, AND THAT IT WAS AFFIXED BY DUE AND REGULAR VILLAGE AUTHORITY, AND THAT SAID INSTRUMENT IS THE FREE ACT AND DEED OF SAID VILLAGE.
WITNESS MY HAND AND OFFICIAL SEAL THIS 17th DAY OF June, 2004.
MY COMMISSION EXPIRES: May 19, 2006
COMMISSION NUMBER: DD11384
Diane Marie DiSanto
NOTARY PUBLIC
PRINT NAME

SURVEYOR'S NOTES

- BUILDING SETBACK LINES SHALL BE REQUIRED BY THE VILLAGE OF ROYAL PALM BEACH UNIFIED LAND DEVELOPMENT CODE (ULDC) AND ORDINANCES OF THE VILLAGE OF ROYAL PALM BEACH.
- THERE SHALL BE NO BUILDING OR ANY HABITABLE STRUCTURE PLACED ON DRAINAGE EASEMENTS OR UTILITY EASEMENTS.
- THERE SHALL BE NO TREES OR SHRUBS PLACED ON UTILITY EASEMENTS WHICH ARE PROVIDED FOR WATER AND SEWER USE OR UPON DRAINAGE EASEMENTS.
- LANDSCAPING ON OTHER UTILITY EASEMENTS SHALL BE ALLOWED ONLY AFTER CONSENT OF ALL UTILITY COMPANIES OCCUPYING SAME.
- IN THOSE CASES WHERE EASEMENTS OF DIFFERENT TYPES CROSS OR OVERLAP, DRAINAGE EASEMENTS SHALL HAVE FIRST PRIORITY, UTILITY EASEMENTS SHALL HAVE SECOND PRIORITY AND ALL OTHER EASEMENTS SHALL BE SUBORDINATE TO THESE WITH THEIR PRIORITIES BEING DETERMINED BY THE USE OF RIGHTS GRANTED.
- P.R.M. PERMANENT REFERENCE MONUMENT
O.R.B. OFFICIAL RECORD BOOK
P.B. PLAT BOOK
P.G. PAGE
U.E. UTILITY EASEMENT
D.E. DRAINAGE EASEMENT
R. RADIUS
L. ARC LENGTH
Δ. CURVE CENTRAL ANGLE
■ DENOTES SET P.R.M. LB #4396
CH.B. CHORD BEARING
L.C. CHORD LENGTH
L.W.D.D. LAKE WORTH DRAINAGE DISTRICT
R.L. RADIAL LINE
- ALL BEARINGS SHOWN HEREON ARE ASSUMED TO BE NON-RADIAL UNLESS OTHERWISE NOTED AS RADIAL (RL).
- BEARINGS AS SHOWN HEREON ARE BASED UPON THE WEST LINE OF TRACT "E", BELLA TERRA P.U.D. PLAT NO. 1 AS RECORDED IN PLAT BOOK 94, PAGES 13 THROUGH 28 PUBLIC RECORDS OF PALM BEACH COUNTY, FLORIDA, HAVING A BEARING OF NORTH 0°29'57" EAST AND ALL OTHER BEARINGS ARE RELATIVE THERETO.
- NOTICE THIS PLAT, AS RECORDED IN ITS GRAPHIC FORM, IS THE OFFICIAL DEPICTION OF THE SUBDIVIDED LANDS DESCRIBED HEREIN, AND WILL IN NO CIRCUMSTANCES BE SUPPLANTED IN AUTHORITY BY ANY OTHER GRAPHIC OR DIGITAL FORM OF THE PLAT. THERE MAY BE ADDITIONAL RESTRICTIONS THAT ARE NOT RECORDED ON THIS PLAT THAT MAY BE FOUND IN THE PUBLIC RECORDS OF THIS COUNTY.

BELLA TERRA COMMUNITY DEVELOPMENT DISTRICT ACKNOWLEDGMENT

THE BELLA TERRA COMMUNITY DEVELOPMENT DISTRICT HEREBY ACKNOWLEDGES THAT THERE ARE NO DEDICATIONS TO, NOR ARE ANY MAINTENANCE RESPONSIBILITIES BEING INCURRED BY, SAID DISTRICT ON THIS PLAT.
DATE: 5/21/04
BELLA TERRA COMMUNITY DEVELOPMENT DISTRICT
ATTEST: *Richard Hans*
RICHARD HANS
SECRETARY, BOARD OF SUPERVISORS
BY: *Michael J. Smolak*
MICHAEL J. SMOLAK
BOARD OF SUPERVISORS

REVIEWING SURVEYOR'S APPROVAL

THIS PLAT HAS BEEN REVIEWED IN ACCORDANCE WITH CHAPTER 177.08(1) F.S. TO DETERMINE THAT ALL DATA REQUIRED BY CHAPTER 177 F.S. IS SHOWN, WHILE RANDOM CHECKS OF GEOMETRIC DATA REFLECT ITS ADEQUACY, NO REPRESENTATION OF THE FULL VERIFICATION OF SAID DATA IS MADE.
REVIEWING SURVEYOR: *Norman J. Howard*
NORMAN J. HOWARD
FLORIDA CERTIFICATE #5776
DATE: 6-02-04

SURVEYOR'S CERTIFICATION

THIS IS TO CERTIFY THAT THE PLAT SHOWN HEREON IS A TRUE AND CORRECT REPRESENTATION OF A SURVEY MADE UNDER MY RESPONSIBLE DIRECTION AND SUPERVISION THAT SAID PLAT IS ACCURATE TO THE BEST OF MY KNOWLEDGE AND BELIEF; THAT PERMANENT REFERENCE MONUMENTS (P.R.M.'S) AND MONUMENTS ACCORDING TO SECTION 177.09(9), F.S. HAVE BEEN PLACED AS REQUIRED BY LAW AND FURTHER THAT THE PLAT COMPLIES WITH ALL THE SURVEY REQUIREMENTS OF CHAPTER 177 FLORIDA STATUTES, AS AMENDED, AND THE ORDINANCES OF THE VILLAGE OF ROYAL PALM BEACH, FLORIDA.
DATE: May 24, 2004
Craig S. Pusey
CRAIG S. PUSEY
PROFESSIONAL SURVEYOR AND MAPPER
CERTIFICATE NO. 5019
1850 FOREST HILL BLVD., SUITE 100
WEST PALM BEACH, FLORIDA 33406
CERTIFICATE OF AUTHORIZATION L.B. #4396

THIS INSTRUMENT WAS PREPARED BY JOHN TRASK UNDER THE SUPERVISION OF CRAIG S. PUSEY, P.S.M. OF LANDMARK SURVEYING AND MAPPING, INC.

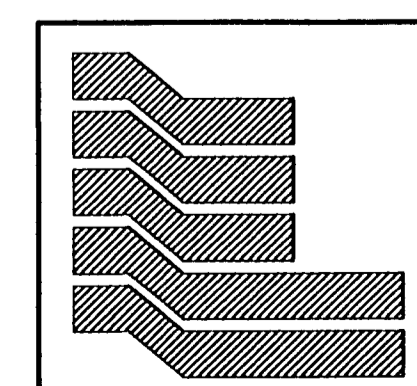
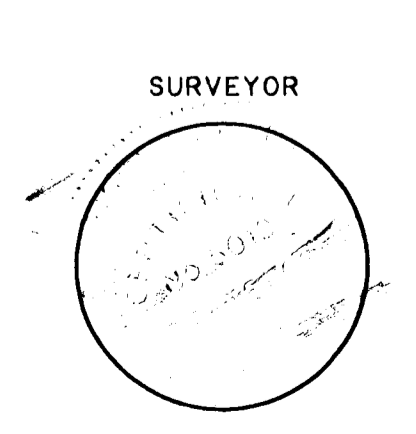
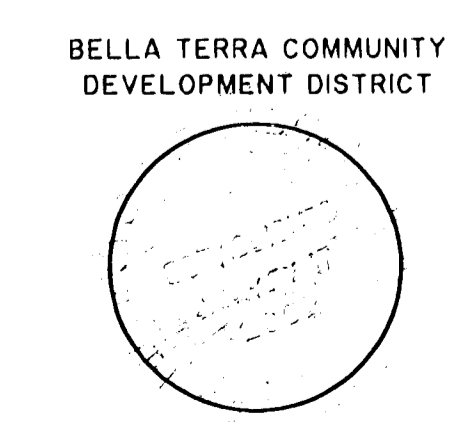
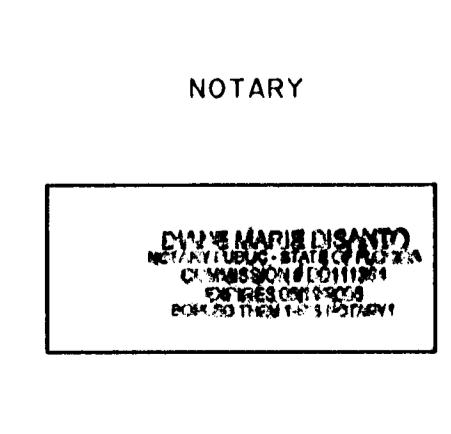
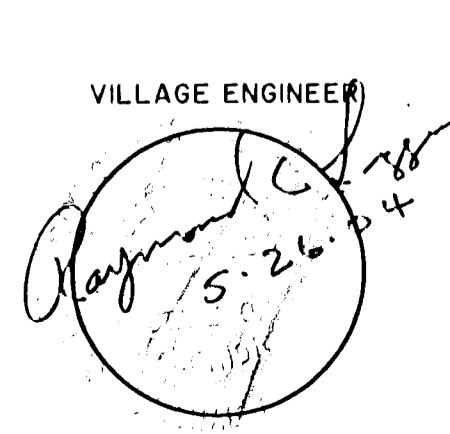
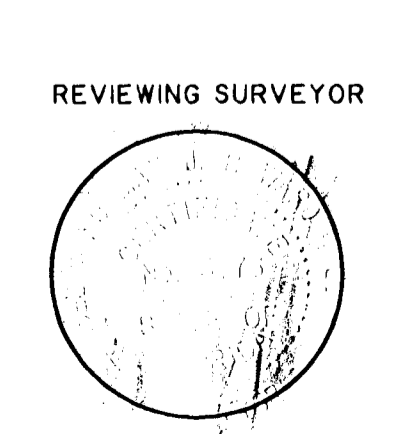
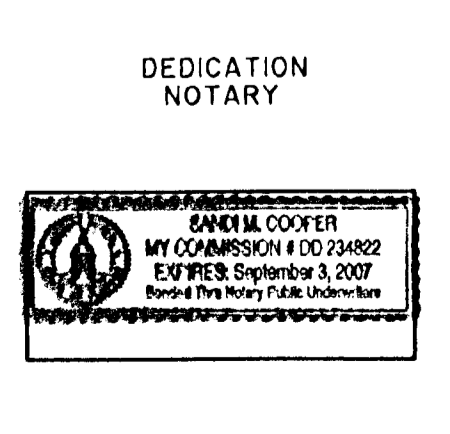
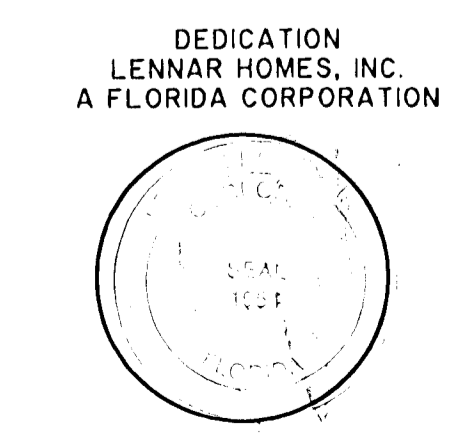

Landmark Surveying & Mapping Inc.
1850 Forest Hill Boulevard
Ph. (561) 433-5405 Suite 100 W.P.B. Florida
LB # 4396
BELLA TERRA P.U.D. PLAT NO. 4
REPLAT